

Version : 2023 Rev.0

Laminar Flow Hood Fan Filter Unit (FFU)

SH-FFU1170



TABLE OF CONTENTS

Keep this manual on-hand so it can be used by all operators of the unit.
Use the unit only in the way described in this manual.
Failure to follow the instruction in this manual may cause wrong operation.

1. General Description	3
2. Graphic Symbols	4
3. The Outward	5
4. Installation	6
5. Setting and Operation	8
6. Specification	9

1. General description

Thank you for purchasing our product. We know that in today's competitive marketplace, customers have many choices when purchasing laboratory equipments.

We appreciate your choosing our quality product. We stand behind our products and want to let you know we are here if you need us.

Before you use the unit, read this entire manual carefully to understand how to install, operate and maintain the unit in a safe manner.

Your satisfaction with the unit will be maximized as you read this manual thoroughly.

Our capable products will satisfy you by the best performance with easy operation.



SH SCIENTIFIC

2. Graphic symbols

BE SURE THAT YOU UNDERSTAND ALL OF THESE SYMBOLS
BEFORE OPERATING THE UNIT.



Important operating and / or maintenance instruction. Read the accompanying text carefully.



This symbol indicates items and procedures that are **STRICTY PROHIBITED** with regards to the unit.



Potential electrical hazards.



Explosive.



No disassemble.



Flammable.



Hot surface or steam.

3. The outward

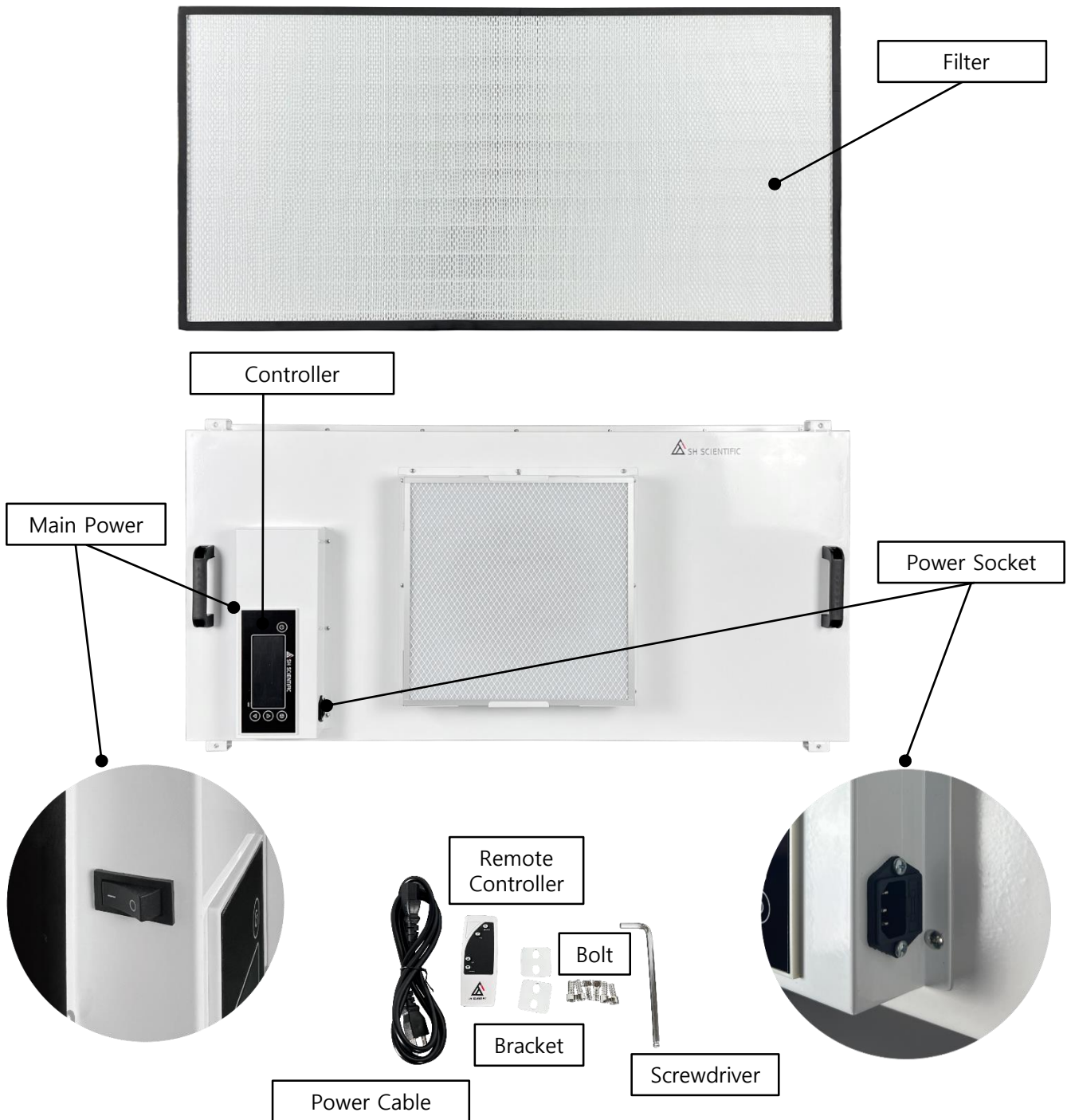

< SH-FFU1170 >

4. Installation

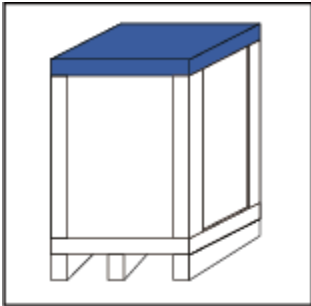

① Once the product is delivered, place the package on a flat location.

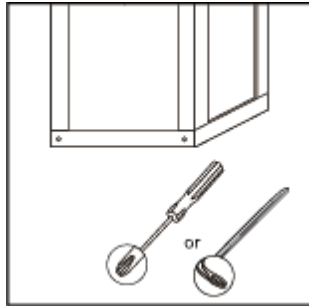

② Unscrew the bottom of the box.



③ Lift the box as shown in the picture.

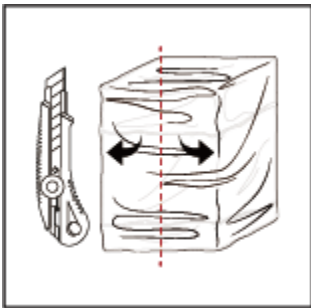

④ Unwrap the bag.

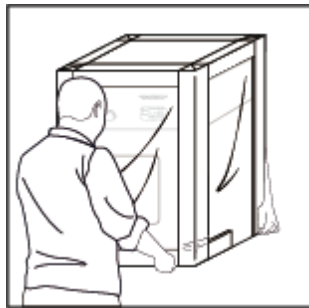

⑤ Place the equipment on your desired location.



⑥ Lift the remaining plastic up.

※ How to stack 2 FFUs

① Stack one FFU on the other FFU.

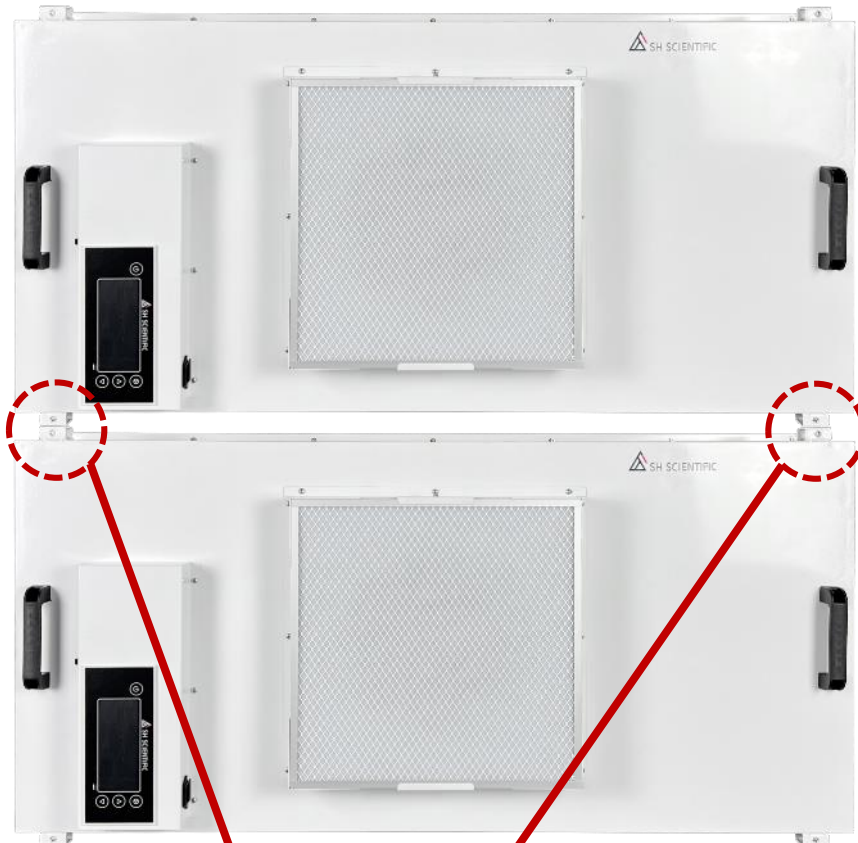

Bracket



Bolt



Screwdriver

②

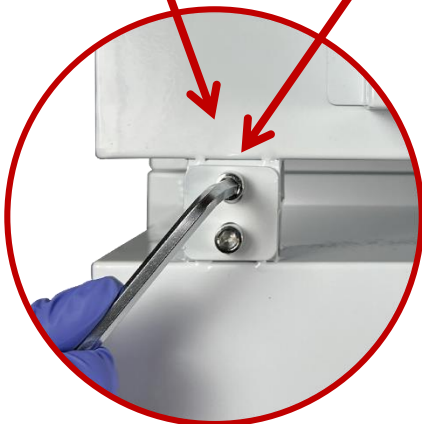

Fasten with brackets and bolts.

③



5. SETTING AND OPERATION

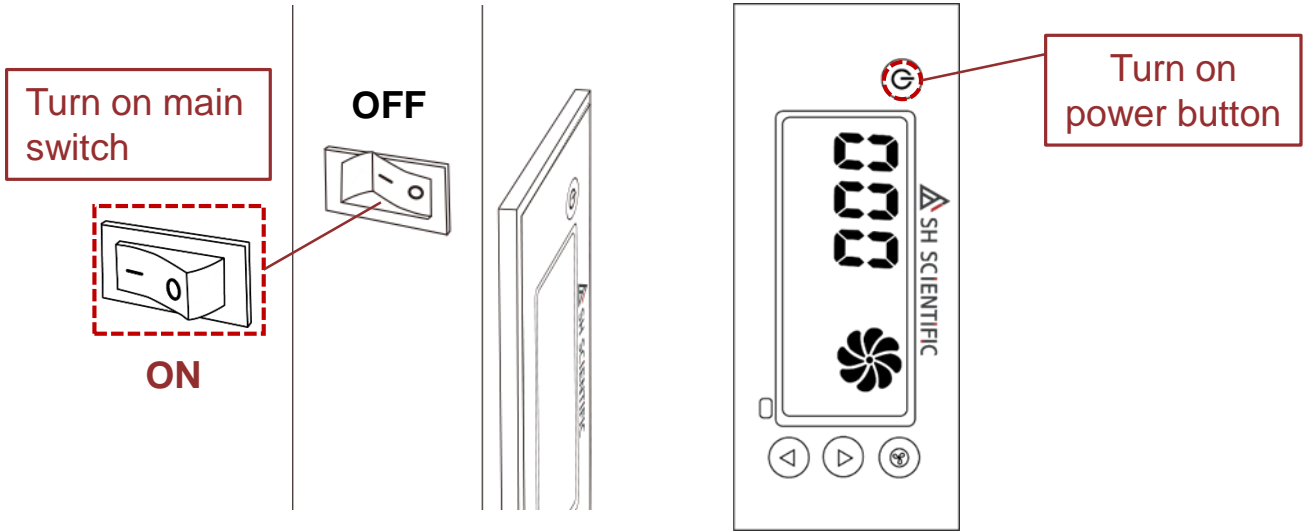

! Display will on when you turn on power switch.

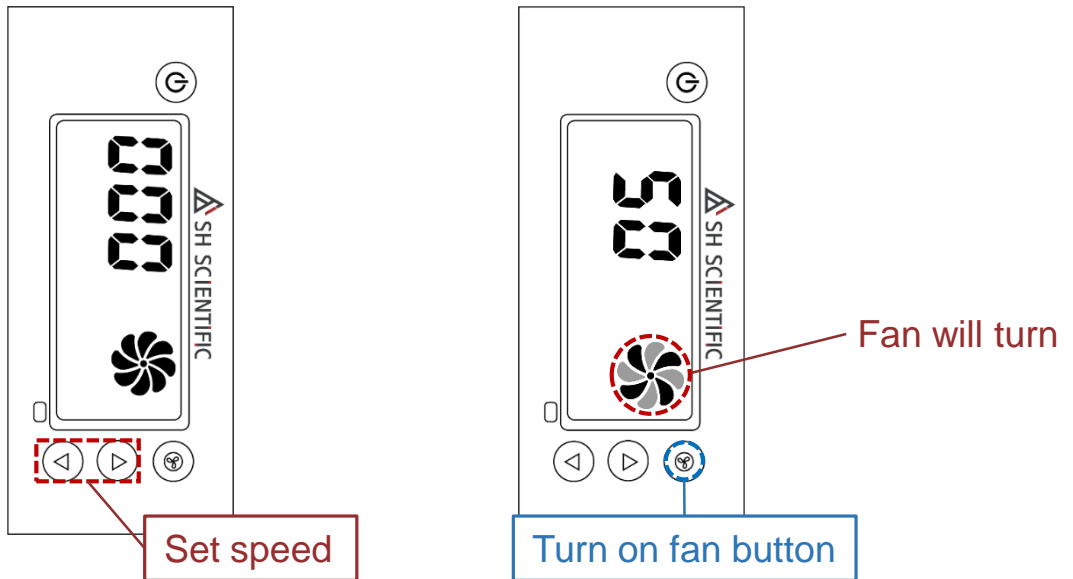

Set your speed first and then turn on fan button.
Touching with glove will not work.

6. Specifications

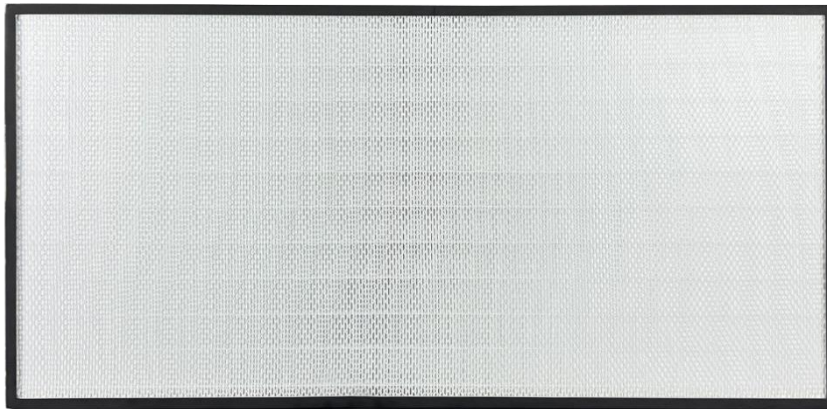

Model	SH-FFU1170
Air Volume	900~2000 m ³ /h
Wind speed	0.45~1.1 m/s
Power	215W
Electrical Requirements 110V 50Hz, 1Φ	13.0 A

